

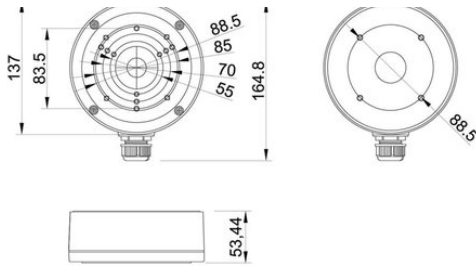

Connection Base

- Concealed Cable Management

DIMENSIONS (mm)



TECHNICAL SPECIFICATIONS

Suitable for:	GCI-F4616T, GCI-F4626T, GCI-F4626V, GCT-K0123T, GCT-K1326T, GCT-K1326V
Body material:	Die cast aluminium
Color:	White
Regulation:	RoHS Compliant
Dimensions (W x H x D):	136 x 165 x 53 mm - 5.35 x 6.5 x 2.09 In:
Weight:	0.545 kg - 1.2 lbs